

# 1. Product main performance/产品主要性能指标:

Operating Temperature/工作温度 : -55°C~150°C  
 Humidity(max)/最大潮湿 : <=95% [at 60 deg C / 140 F]  
 Shielding /屏蔽性能 : 75dB(10MHz) 40dB(1GHz)  
 Salt Spray Corrosion/盐雾 : 96hr

## Mechanical data/机械特性:

Vibration/振 动 : 15g[10Hz~2000Hz]  
 Shock Resistance/冲 击 : 100g[6ms]  
 Endurance (Shell)/机械寿命 : 5000+  
 Cable/配接电缆: Φ3.1mm-Φ4.0mm

## 2. 电气性能

Insert Configuration/针芯配置: 1BP.308 8Low Voltage  
 Pin Size/接触件直径: Φ0.7mm  
 Contact resistance接触电阻: ≤12.5mΩ  
 Insulation resistance/绝缘电阻: 5000MΩ (测试电压500V(DC))  
 Withstand voltage/耐电压: 950V(AC)  
 Rated working current额定工作电流: 5.0A

## Other Specification/其它规格:

Contact PIN/接触体: Gold plated Tin bronze/锡青铜镀金  
 Housing Material/外壳材质: PEEK  
 Other Shell Material/其它壳体材质: 铜镀镍  
 Insulator material/绝缘体材料: PPS  
 IP Rating/防护等级 : IP50

\*ALL MATERIALS ARE RoHS COMPLIANT/所有材料均符合RoHS要求.

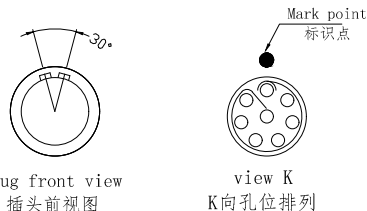
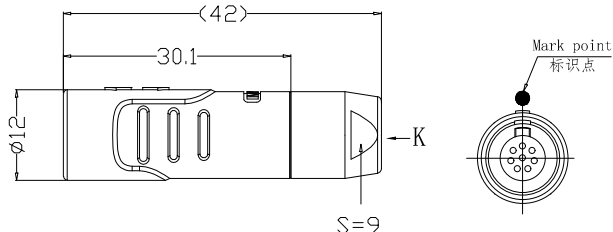

DRAWN BY:  
绘图: P003 2024.05.28  
 CHECKED BY:  
审核: Z01 2024.05.28  
 APPROVED BY:  
核准: P005 2024.05.28



美易连电子科技(深圳)有限公司  
 Meiyilian electronic technology (shenzhen) Co., Ltd.

GENERAL TOLERANCE  
(UNLESS SPECIFIED)

≤10 ±0.1  
 <10° ≤20 ±0.15  
 <20° ≤50 ±0.3  
 Angle ±1°

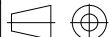

FIRST ANGLE PROJECTION

单位  
UNIT: mm

比例  
SCALE: 1:1

名称  
PART NAME

型号  
PART NAME

REV/版本

A1

SHREFF: 1 OF 1

名称  
PART NAME

型号  
PART NAME

DHA-1BP浮动式插座 (不带护套尾帽)  
 DHA-1BP Floating socket  
 (without jacketed tail cap)

型号  
PART NAME

DHA. 1BP. 308. KWLLD42