

1. Product main performance/产品主要性能指标:

Operating Temperature/工作温度: $-55^{\circ}\text{C} \sim 150^{\circ}\text{C}$
 Humidity(max)/最大潮湿: $<95\%$ [at $60^{\circ}\text{C} / 140^{\circ}\text{F}$]
 Shielding /屏蔽性能: $75\text{dB}(10\text{MHz}) \quad 40\text{dB}(1\text{GHz})$
 Salt Spray Corrosion/盐雾: 96hr

Mechanical data/机械特性:

Vibration/振动: $15\text{g}[10\text{Hz} \sim 2000\text{Hz}]$
 Shock Resistance/冲击: $100\text{g}[6\text{ms}]$
 Endurance (Shell)/机械寿命: 5000+
 Cable/配接电缆: $\phi 2.4\text{mm} - \phi 3.3\text{mm}$

2. 电气性能

Insert Configuration/针芯配置: 1BP. 314 14Low Voltage
 Pin Size/接触件直径: $\phi 0.5\text{mm}$
 Contact resistance接触电阻: $\leq 15\text{m}\Omega$
 Insulation resistance/绝缘电阻: $5000\text{M}\Omega$ (测试电压 $500\text{V}(\text{DC})$)
 Withstand voltage/耐电压: $750\text{V}(\text{AC})$
 Rated working current额定工作电流: 2.0A

Other Specification/其它规格:

Contact PIN/接触体: Gold plated Tin bronze/锡青铜镀金
 Housing Material/外壳材质: PEEK
 Other Shell Material/其它壳体材质: 铜镀镍
 Insulator material/绝缘体材料: PEEK
 IP Rating/防护等级: IP50

*ALL MATERIALS ARE RoHS COMPLIANT/所有材料均符合RoHS要求.

| REV/版本 | DESCRIPTION/变更内容 | DATE/日期 | DRAWN BY/制图 |
|--------|------------------|---------|-------------|
| | | | |

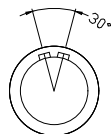
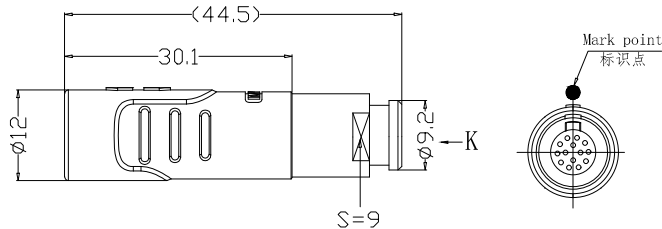

Plug front view
插头前视图

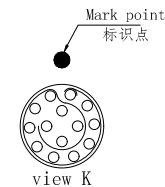

view K
K向孔位排列

| | |
|-----------------------------------------|-----------------|
| DRAWN BY: 绘图: P903 | 2024. 05. 28 |
| CHECKED BY: 审核: Z01 | 2024. 05. 28 |
| APPROVED BY: 核准: P903 | 2024. 05. 28 |
| GENERAL TOLERANCE (UNLESS SPECIFIED) | |
| ≤ 10 | ± 0.1 |
| $< 10 \sim \leq 20$ | ± 0.15 |
| $< 20 \sim \leq 50$ | ± 0.3 |
| Angle | $\pm 1^{\circ}$ |



美易连电子科技(深圳)有限公司
 Meiyilian electronic technology (shenzhen) Co., Ltd.

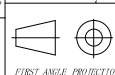

FIRST ANGLE PROJECTION

| 单位 UNT: mm | 名称 PART NAME |
|-------------------|------------------------------------------------------------------------------|
| 比例 SCALE: 1: 1 | DHA-1BP浮动式插座 (带护套式尾帽) DHA-1BP Floating socket (with jacketed tail cap) |
| 尺寸 SIZE: A1 | 型号 PART NAME |
| REV/版本 A1 | SHEET: 1 OF 1 DHA. 1BP. 314. KWKL35Z |

1

2

<https://www.mylconnector.com/>

4

5

<https://www.mylconnector.com/>

7

8