

1. Product main performance/产品主要性能指标:

Operating Temperature/工作温度:  $-55^{\circ}\text{C} \sim 150^{\circ}\text{C}$   
 Humidity(max)/最大潮湿:  $<=95\%$  [at  $60 \text{ deg C} / 140 \text{ F}$ ]  
 Shielding /屏蔽性能:  $75\text{dB}(10\text{MHz}) \quad 40\text{dB}(1\text{GHz})$   
 Salt Spray Corrosion/盐雾: 96hr

Mechanical data/机械特性:

Vibration/振动:  $15\text{g}[10\text{Hz} \sim 2000\text{Hz}]$   
 Shock Resistance/冲击:  $100\text{g}[6\text{ms}]$   
 Endurance (Shell)/机械寿命:  $5000+$   
 Cable/配接电缆:  $\phi 4.1\text{mm} - \phi 5.0\text{mm}$

2. 电气性能

Insert Configuration/针芯配置: 3BP. 308 8Low Voltage  
 Pin Size/接触件直径:  $\phi 1.3\text{mm}$   
 Contact resistance接触电阻:  $\leq 5\text{m}\Omega$   
 Insulation resistance/绝缘电阻:  $5000\text{M}\Omega$  (测试电压 $500\text{V}(\text{DC})$ )  
 Withstand voltage/耐电压:  $1650\text{V}(\text{AC})$   
 Rated working current额定工作电流:  $13.0\text{A}$

Other Specification/其它规格:

Contact PIN/接触体: Gold plated Tin bronze/锡青铜镀金  
 Housing Material/外壳材质: PEEK  
 Other Shell Material/其它壳体材质: 铜镀镍  
 Insulator material/绝缘体材料: PPS  
 IP Rating/防护等级: IP50

\*ALL MATERIALS ARE RoHS COMPLIANT/所有材料均符合RoHS要求.

| REV/版本 | DESCRIPTION/变更内容 | DATE/日期 | DRAWN BY/制图 |
|--------|------------------|---------|-------------|
|        |                  |         |             |

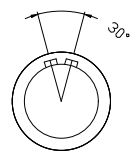
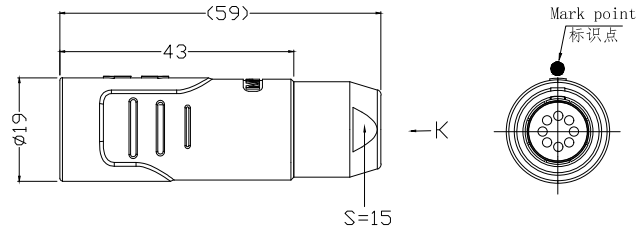

Socket front view  
插座前视图

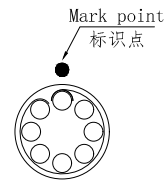

view K  
K向孔位排列

|  |  |  |   |   |
|--|--|--|---|---|
| DRAWN BY:<br>绘图: P003<br>CHECKED BY:<br>审核: Z01<br>APPROVED BY:<br>核准: P005  | 2024.05.28<br>2024.05.28<br>2024.05.28 |  | 美易连电子科技(深圳)有限公司<br>Meiyilian electronic technology (shenzhen) Co., Ltd.                             |   |
| GENERAL TOLERANCE<br>(UNLESS SPECIFIED)<br>$\leq 10 \pm 0.1$<br>$< 10^{\circ} \sim \leq 20 \pm 0.15$<br>$< 20^{\circ} \sim \leq 50 \pm 0.3$<br>Angle $\pm 1^{\circ}$ |  | 单位<br>UNT: mm<br>比例<br>SCALE: 1:1<br>型号<br>PART NAME | 名称<br>PART NAME<br>DHA-3BP浮动式插座 (不带护套式尾帽)<br>DDH-3BP Floating socket<br>(without jacketed tail cap) | 型号<br>PART NAME<br>DHA. 3BP. 308. KWLLD52 |
| REV/版本<br>A1   | SHEET: 1 OF 1                          | 单位<br>A1   | SHEET: 1 OF 1   |   |