

1. Product main performance/产品主要性能指标:

Operating Temperature/工作温度: $-55^{\circ}\text{C} \sim 150^{\circ}\text{C}$
 Humidity(max)/最大潮湿: $\leq 95\%$ [at $60^{\circ}\text{C} / 140^{\circ}\text{F}$]
 Shielding /屏蔽性能: $75\text{dB}(10\text{MHz}) \quad 40\text{dB}(1\text{GHz})$
 Salt Spray Corrosion/盐雾: 96hr

Mechanical data/机械特性:

Vibration/振动: $15\text{g}[10\text{Hz} \sim 2000\text{Hz}]$
 Shock Resistance/冲击: $100\text{g}[6\text{ms}]$
 Endurance (Shell)/机械寿命: $5000+$
 Cable/配接电缆: $\phi 10.1\text{mm} - \phi 11.0\text{mm}$

2. 电气性能

Insert Configuration/针芯配置: 4BP. 310 10Low Voltage
 Pin Size/接触件直径: $\phi 1.6\text{mm}$
 Contact resistance接触电阻: $\leq 4\text{m}\Omega$
 Insulation resistance/绝缘电阻: $5000\text{M}\Omega$ (测试电压 $500\text{V}(\text{DC})$)
 Withstand voltage/耐电压: $1850\text{V}(\text{AC})$
 Rated working current额定工作电流: 17.0A

Other Specification/其它规格:

Contact PIN/接触体: Gold plated Tin bronze/锡青铜镀金
 Housing Material/外壳材质: PEEK
 Other Shell Material/其它壳体材质: 铜镀镍
 Insulator material/绝缘体材料: PPS
 IP Rating/防护等级: IP50

*ALL MATERIALS ARE RoHS COMPLIANT/所有材料均符合RoHS要求.

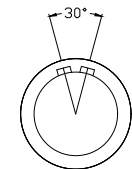
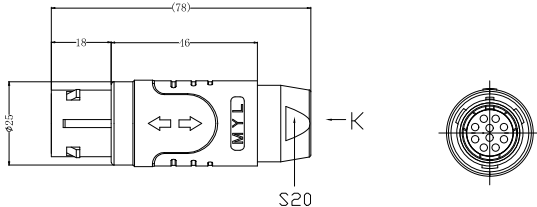

Plug front view
插头前视图

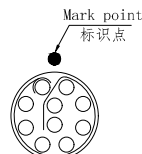

view K
K向孔位排列

DRAWN BY: 绘图: PPO3 2024.03.28
 CHECKED BY: 审核: Z01 2024.03.28
 APPROVED BY: 批准: PPO3 2024.03.28



美易连电子科技(深圳)有限公司
 Meiyilian electronic technology (shenzhen) Co., Ltd.

GENERAL TOLERANCE
(UNLESS SPECIFIED)

$\leq 10 \pm 0.1$
 $< 10^{\circ} \sim \leq 20 \pm 0.15$
 $< 20^{\circ} \sim \leq 50 \pm 0.3$
 Angle $\pm 1^{\circ}$

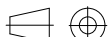

FIRST ANGLE PROJECTION

单位
UNIT: mm

比例
SCALE: 1: 1

名称
PART NAME

型号
PART NAME

REV/版本
A1

SHEET: 1 OF 1

名称
PART NAME

型号
PART NAME

TG-4BP直式插头(不带护套式尾帽)
 TG-4BP Straight Plug
 (without jacketed tail cap)

TGA. 4BP. 310. KWLAD112